

-  Officer Directing Signals at Cabinet
-  Flagman
-  Light Plant
-  Plastic Drum
-  Type III Road Closed Barricade

STA. 449+82.51 @ CONST. S.R. 200 =
STA. 30+00.00 @ CONST. C.R. 107

**ROAD
CLOSED**

SPEED
LIMIT
45



SHARE
THE
ROAD

TO BE PLACED ON TYPE III
BARRICADES (TYP.)

MATCHLINE STA. 445+00.00

MATCHLINE STA. 450+60.00

Lighted Work Zone Ahead VMB

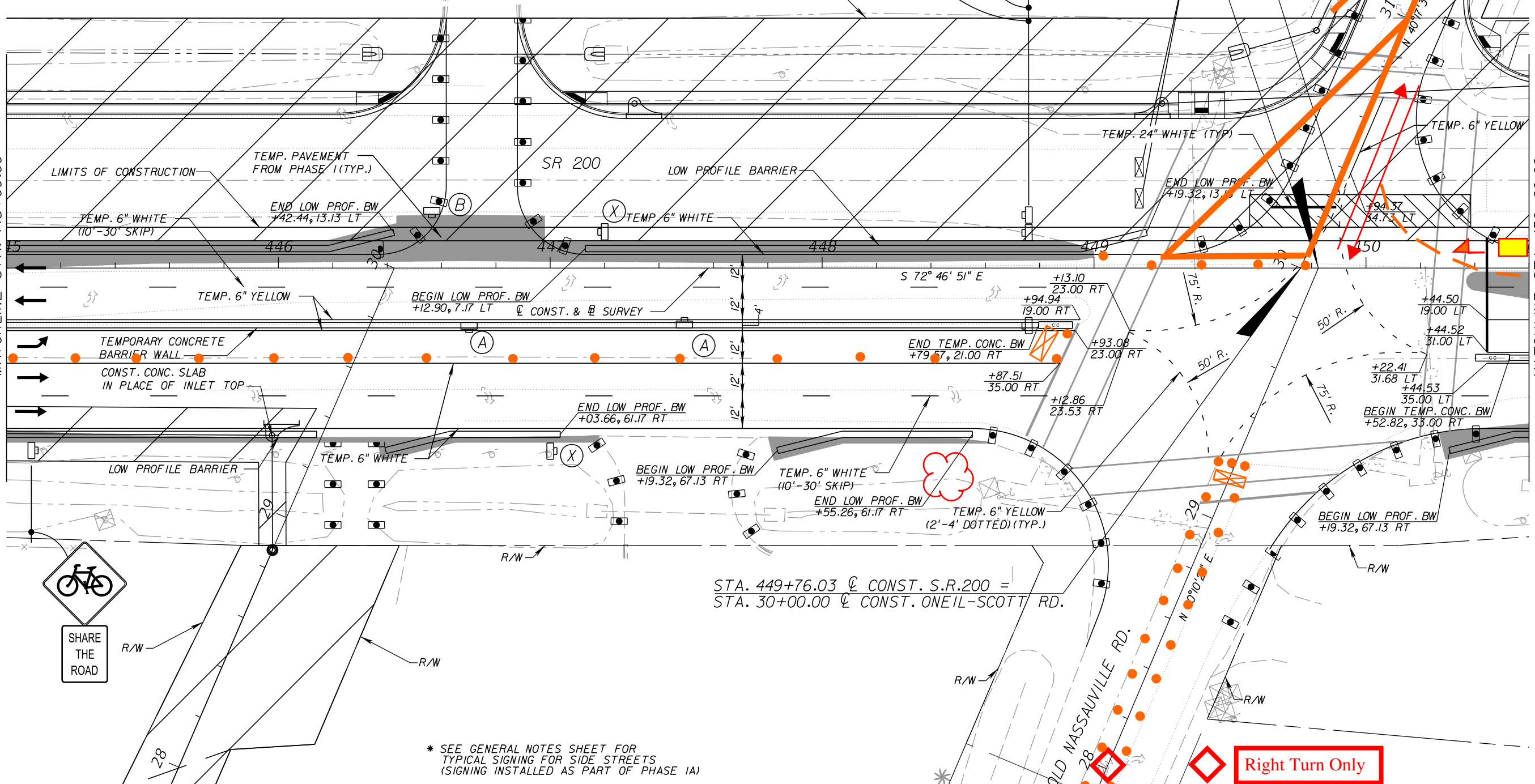

STA. 449+76.03 @ CONST. S.R.200 =
STA. 30+00.00 @ CONST. ONEIL-SCOTT RD.

* SEE GENERAL NOTES SHEET FOR
TYPICAL SIGNING FOR SIDE STREETS
(SIGNING INSTALLED AS PART OF PHASE 1A)

REVISIONS				ARCADIS 1650 Prudential Drive, Suite 400 Jacksonville, Florida 32207 T: 904 721 2991 F: 904 861 2450 Certificate of Authorization No. 7917 Gene Howerton, PE No. 43992	STATE OF FLORIDA DEPARTMENT OF TRANSPORTATION			TRAFFIC CONTROL PLAN PHASE 2A	SHEET NO.
DATE	DESCRIPTION	DATE	DESCRIPTION		ROAD NO.	COUNTY	FINANCIAL PROJECT ID		823
					SR 200	NASSAU	210712-4-52-01		

NOTICE: THE OFFICIAL RECORD OF THIS SHEET IS THE ELECTRONIC FILE SIGNED AND SEALED UNDER RULE 61G15-23.003, F.A.C.